

# FF

## // Applications

FF Series couplings are widely used in the public utility market where hydraulic oil spillage can constitute a serious safety hazard, particularly in overhead bucket hoists that are used for maintenance of high-voltage power transmission lines. These couplings are also used for quick change of hydraulic tools in construction, railway maintenance and mining industries. The ease of cleaning makes them ideal for use in these types of hostile environments.

## // Features

- Steel construction, zinc plated with yellow chromate finish. Hardened nipples and sleeves and solid barstock construction for maximum resistance to damage from hydraulic and mechanical shock.
- This Anti-Blowout Nitrile/PTFE bonded seals designed to prevent blow-out or damage during severe service conditions.
- Durable ball-locking mechanism assures reliable connections every time. A large number of locking balls distributes the workload evenly while providing alignment and swiveling action to reduce hose torque and prolong hose life.
- CAUTION: These products are not to be used as swivels.
- Rotation under pressure will result in excessive and premature wear.
- FF Series couplings employ flush valving when connecting or disconnecting.
- This means that the valves are mated together so that only small amounts of fluid can be lost during disconnection or air inclusion during reconnection.
- New chrome plating treatment provides advanced anti-rust performance.
- FF series conforms to standard of ISO16028.

## // Specifications

Body Size/(inch)	1/4(02)	3/8(03)	1/2(04)	5/8(06)	3/4(08)	1(10)	1-1/2(12)	2(16)
Rated Pressure/(Psi)	5000	4350	4350	3625	3625	3000	3000	3000
Rated Flow/(GPM)	3	6	12	20	28	50	80	100
Spillage/(ML)	0.006	0.012	0.02	0.026	0.032	0.035	0.05	0.1
Temperature Range	-20°C to +120°C							
Standard seal material	NBR							

## // Performance

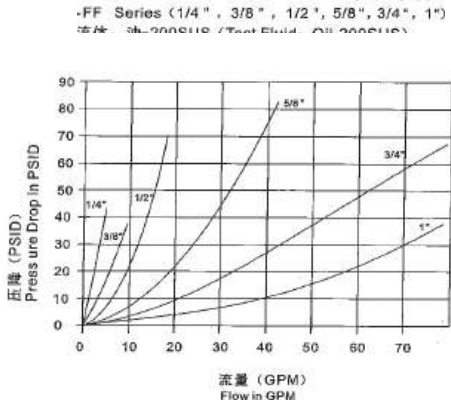

1 GPM=3.78L/Min 1PSID=0.00703MPa

### Socket

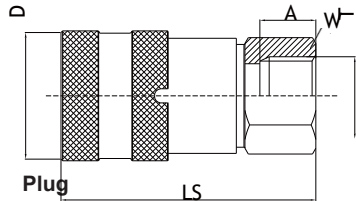

### Plug

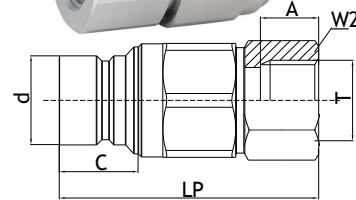

### Coupling Fitting

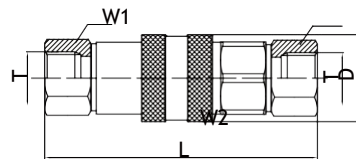

ISO	Part No.	LS	D	W1	A	T	Unit Price(\$)
6.3	FF-02SF	58.2	φ28	28	14	G1/4 NPT1/4	*
10	FF-03SF	68.2	φ32	32	14	G3/8 NPT3/8	*
10	FF-03SF	72.2	φ32	32	18	G1/2 NPT1/2	*
12.5	FF-04SF	75	φ38	38	18	G1/2 NPT1/2	*
12.5	FF-04SF	79	φ38	38	22	G3/4 NPT3/4	*
16	FF-06SF	80	φ42	42	22	G3/4 NPT3/4	*
19	FF-08SF	99.8	φ48	48	22	G3/4 NPT3/4	*
19	FF-08SF	99.8	φ48	48	23.5	G1 NPT1	*
25	FF-10SF	111.5	φ56	56	24	G1-1/4 NPT1-1/4	*
-	FF-12SF	150	φ79.5	79.5	30	G1-1/2 NPT1-1/2	*
-	FF-16SF	167	φ98.5	98.5	31	G2 NPT2	*

ISO	Part No.	LP	d	C	W2	A	T	Unit Price(\$)
6.3	FF-02PF	49.2	16.1	15.2	20	14	G1/4 NPT1/4	*
10	FF-03PF	55.8	19.7	19.5	24	14	G3/8 NPT3/8	*
10	FF-03PF	59.8	19.7	19.5	27	18	G1/2 NPT1/2	*
12.5	FF-04PF	72	24.5	21.6	32	18	G1/2 NPT1/2	*
12.5	FF-04PF	76	24.5	21.6	36	22	G3/4 NPT3/4	*
16	FF-06PF	75.6	27	21.6	36	22	G3/4 NPT3/4	*
19	FF-08PF	93.8	30	29	41	22	G3/4 NPT3/4	*
19	FF-08PF	93.8	30	29	41	23.5	G1 NPT1	*
25	FF-10PF	90	36	34	55	24	G1-1/4 NPT1-1/4	*
-	FF-12PF	112	57	38	65	30	G1-1/2 NPT1-1/2	*
-	FF-16PF	123.9	73	40.5	75	31	G2 NPT2	*

ISO	Part No.	L	D	W1	W2	T	Unit Price(\$)
6.3	FF-02	49.2	φ28	28	20	G1/4 NPT1/4	*
10	FF-03	55.8	φ32	32	24	G3/8 NPT3/8	*
10	FF-03	59.8	φ32	32	27	G1/2 NPT1/2	*
12.5	FF-04	72	φ38	38	32	G1/2 NPT1/2	*
12.5	FF-04	76	φ38	38	36	G3/4 NPT3/4	*
16	FF-06	75.6	φ42	42	36	G3/4 NPT3/4	*
19	FF-08	93.8	φ48	48	41	G3/4 NPT3/4	*
19	FF-08	93.8	φ48	48	41	G1 NPT1	*
25	FF-10	90	φ56	56	55	G1-1/4 NPT1-1/4	*
-	FF-12	112	φ79.5	79.5	65	G1-1/2 NPT1-1/2	*
-	FF-16	123.9	φ98.5	98.5	75	G2 NPT2	*

